



AVK WALL PENSTOCK WITH NON-RISING STEM

772/61

Closed frame for wall mounting, AISI 304, EPDM

001

AVK wall penstocks are square or rectangular with resilient sealing on all four sides of the slide. They are bi-directional up to and including 1200 X 1200 and in larger sizes available as bi- and uni-directional. The penstocks are with non-rising stem and closed frame, and are designed for wall mounting. AVK wall penstocks are also available with rising stem and for embedding in concrete. All penstocks in the comprehensive product range feature a low leakage rate and a reliable operation.

Product Description:

AVK wall penstock with non-rising stem for water and wastewater treatment

Standards:

- Designed according to DIN 19569-4

Features:

- Fulfills requirements of Directive 95/9/CE (ATEX), Group II Category 2 (Zone 1)
- Lower leakage rate than max. allowable in DIN 19569-4 (class 5): 1,20 L/min. per seating meter
- Frame design allows easy mounting at medium height or floor level, and for elevated or flush bottom installation
- Self-cleaning guides of HMWPE (high molecular weight polyethylene) reduce the friction during operation resulting in easy operation and extended seal durability
- Self-adjusting "lip-design" sealing of EPDM mounted on the frame
- Frame and slide of stainless steel AISI 304 and stem of stainless steel AISI 303
- All fasteners of stainless steel A2
- Seal and guides bolting is completely separated from the frame anchoring
- Delivered with handwheel up to and including 1000X1000, in larger sizes with bevelgear

Accessories:

Handwheel on inclined wall stand, handwheel on straight floor stand, gear operator on straight floor stand, electric actuator on straight floor stand, hydraulic actuator, pneumatic actuator, yoke mounted handwheel, yoke mounted gear and crank, stem nut, stem extensions, stem guides and wall thimbles



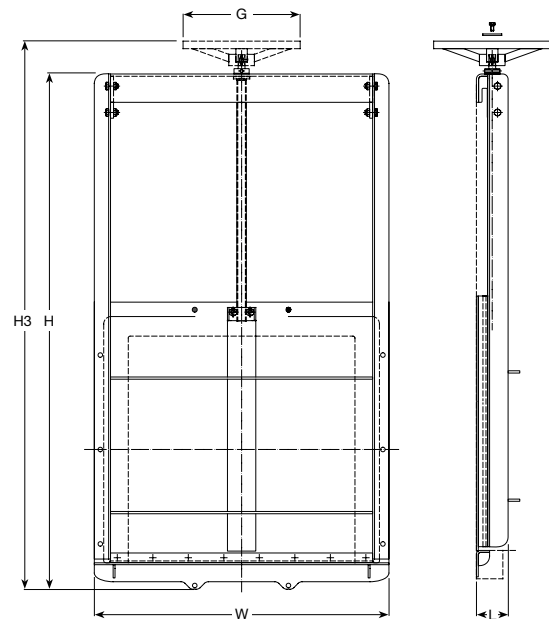
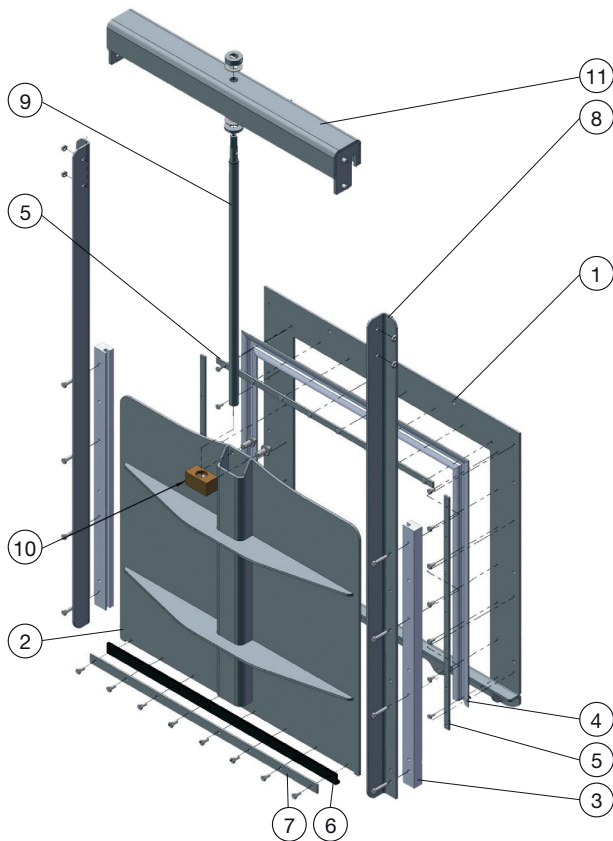

Component List:

1. Frame	Stainless steel AISI 304	2. Slide	Stainless steel AISI 304
3. Guide	HMWPE	4. Seal	EPDM rubber
5. Seal retainer	Stainless steel AISI 304	6. Bottom seal	EPDM rubber
7. Bottom seal retainer	Stainless steel AISI 304	8. Frame guide	Stainless steel AISI 304
9. Stem	Stainless steel AISI 303	10. Stem nut	Bronze
11. Yoke	Stainless steel AISI 304		

Components may be substituted with equivalent or higher class materials without prior notification.

Reference Nos. and Dimensions:

AVKI No.	AVK ref. nos	Size mm	H mm	H3 mm	G mm	L mm	MWC seat mm	MWC unseat mm	W mm	Theoretical weight kg
772-000012	772-02000200-61-521001	200 - 200	492	626	225	82	10	10	380	16
772-000013	772-03000300-61-521001	300 - 300	692	826	225	82	10	10	480	23
772-000014	772-04000400-61-521001	400 - 400	893	1045	310	85	10	10	580	41
772-000015	772-05000500-61-521001	500 - 500	1093	1245	310	85	10	10	680	52
772-000016	772-06000600-61-521001	600 - 600	1294	1446	310	115	10	10	780	67
772-000017	772-07000700-61-521001	700 - 700	1496	1648	310	115	10	10	880	80
772-000018	772-08000800-61-521001	800 - 800	1696	1848	310	125	10	10	980	96
772-000019	772-09000900-61-521001	900 - 900	1976	2143	410	136	10	10	1100	147
772-000020	772-10001000-61-521001	1000 - 1000	2176	2343	410	136	10	10	1200	168
772-000021	772-11001100-61-221021	1100 - 1100	2389	2671	300	136	6	6	1300	209
772-000022	772-12001200-61-221021	1200 - 1200	2589	2871	300	136	6	6	1400	242